

Urgent Return receipt Expand Group Restricted Prevent Copy

Jackson Chak Sang CHAN/PLAND

寄件者: 新豐 建築工程有限公司 <[REDACTED]>
寄件日期: 2026年04月01日星期三 17:26
收件者: TPB Submission/PLAND
副本: Jackson Chak Sang CHAN/PLAND; Peter Pak Lun NGAN/PLAND
主旨: 有關規劃申請編號 A/NE-LYT/873 & A/NE-LYT/874
附件: 1588S.A Justifications.pdf; 1588SA BL.pdf; 1588SB BL.pdf; 1588SB Justifications.pdf
類別: Internet Email

規劃專員你好, 此電郵中之附件為最新版本之文件, 取代之前提提交的版本, 謝謝

如有問題可聯絡鄧文浩先生. TEL: [REDACTED]

PROPOSED BUILDING LICENCE LOT No. 1588 S. B IN D. D. 83

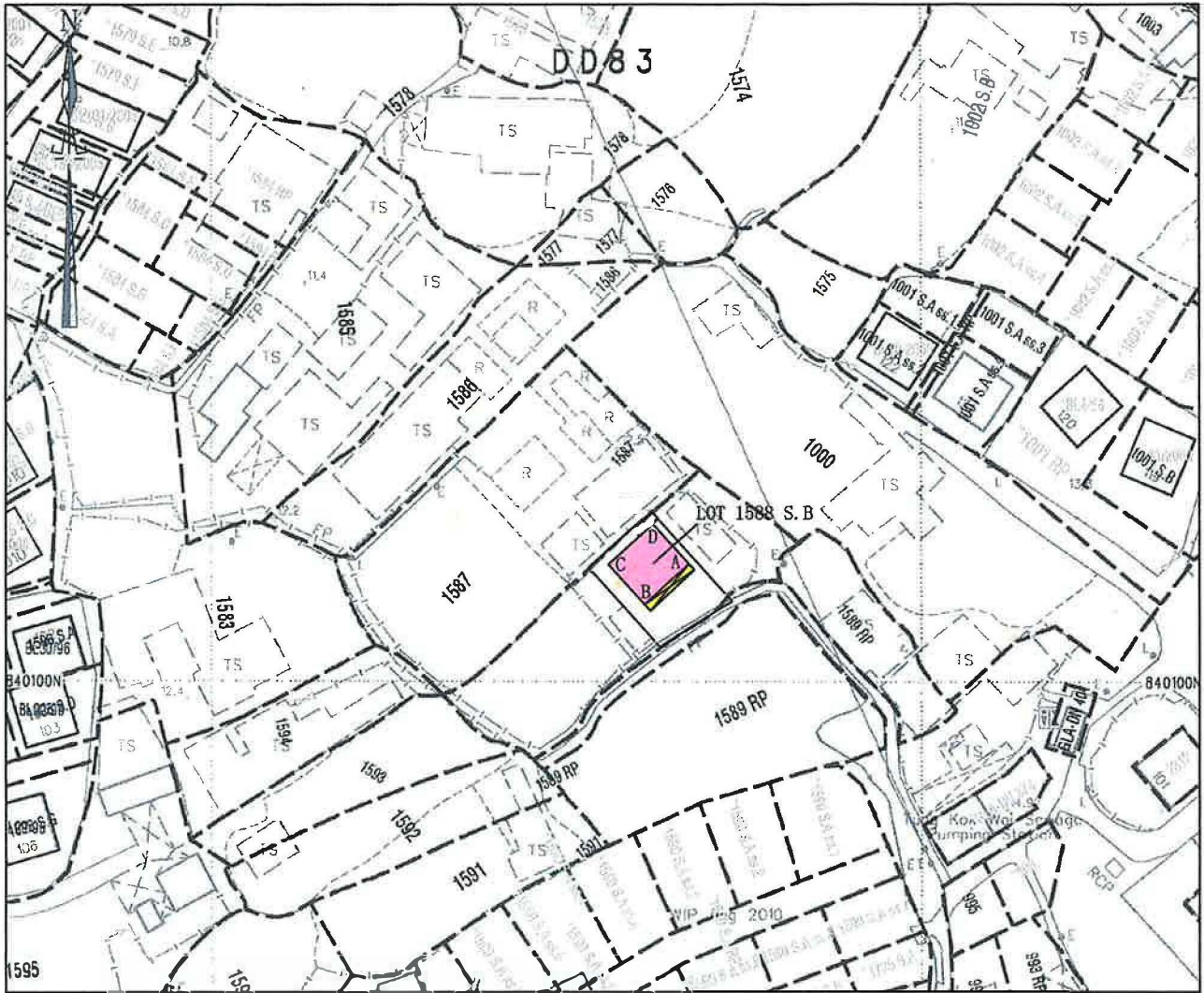

LOCATION PLAN

COLORED PINK AREA = 65.03 SQUARE METRES (ABOUT)

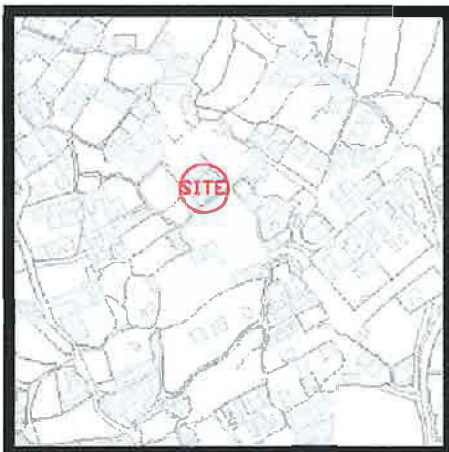

Line	Bearing	Distance (M)	Nothing	Easting	Pt.
A-B	227°50'24"	8.534	840 116. 522	833 767. 322	A
B-C	317°50'24"	7.620	840 110. 794	833 760. 996	B
C-D	47°50'24"	8.534	840 116. 442	833 755. 881	C
D-A	137°50'24"	7.620	840 122. 171	833 762. 207	D

Remarks:

Please refer to SRP No. SRP/DN/054/0749/D1 for boundary information of Lot No. 1588 S. B in D. D. 83

Legends:

☒ Balcony (8.534m x 1.220m) colored yellow

Scale 1:1000

Survey Sheet No. : 3-SW-8C, 3-SW-8D

Date : April 2014



卓 弘 測 量 服 務 公 司
CHUO WANG SURVEY SERVICES COMPANY